

Please read and save these instructions. Read through this owner's manual carefully before using product. Protect yourself and others by observing all safety information, warnings, and cautions. Failure to comply with instructions could result in personal injury and/or damage to product or property. Please retain instructions for future reference.

essentials®

PORTABLE ELECTRIC SPACE HEATER

FOR CUSTOMER SERVICE

Technical Question?

CALL 1-866-458-2472

UNPACKING

After unpacking the unit, inspect carefully for any damage that may have occurred during transit. Check for loose, missing, or damaged parts. If any damage is observed, a shipping damage claim must be filed with the carrier. DO NOT use the Essentials® 25998 Portable Electric Space Heater if broken, bent, cracked or damaged parts (including labels) are noted. Any Space Heater that appears damaged in any way, operates abnormally or is missing parts should be removed from service immediately. If you suspect that the Space Heater was subjected to shock load (a load that was dropped suddenly, unexpectedly, etc.), immediately discontinue use until it has been checked by a factory authorized service center.



⚠ WARNING

The following safety information is provided as a guideline to help you operate your Space Heater under the safest possible conditions. Any tool or piece of equipment can be potentially dangerous to use when safety or safe handling instructions are not known or not followed. The following safety instructions are to provide the user with the information necessary for safe use and operation. Please read and retain these instructions for the continued safe use of your Space Heater. Failure to follow instructions listed below may result in serious injury. In addition, make sure that anyone who uses the equipment understands and follows these safety instructions as well.

Explanation of Safety Signal Words

⚠ WARNING: Indicates a potentially hazardous situation which, if not avoided, could result in death or serious injury.

NOTES: Provide clarity and helpful information.

Thank you very much for choosing an Essentials® Product!

For future reference, please register your new tool at www.oem-tools.com and complete the owner's record below:

Model: _____ Purchase Date: _____

Save the receipt, warranty and these instructions. It is important that you read the entire manual to become familiar with this product before you begin using it. This product is designed for certain applications only. Essentials® cannot be responsible for issues arising from modification. We strongly recommend that this product is not modified and/or used for any application other than that for which it was designed. If you have any questions relative to a particular application, DO NOT use the product until you have first contacted customer service to determine if it can or should be performed on the product.

essentials®

PORTABLE ELECTRIC SPACE HEATER

IMPORTANT INSTRUCTIONS AND SAFETY RULES

1. Know your product. Read this manual carefully. Learn the product's applications and limitations, as well as potential hazards specific to it.
2. Keep area clean and well lit. Cluttered or dark areas invite accidents.
3. Never let a child handle tools or equipment without strict adult supervision.
4. DO NOT operate this product if under the influence of alcohol or drugs. Read warning labels on prescriptions to determine if your judgment or reflexes are impaired while taking drugs. If there is any doubt, DO NOT attempt to operate.
5. Wear proper apparel. Loose clothing, gloves, neck-ties, rings, bracelets or other jewelry may present a potential hazard when operating this product. Keep all apparel clear of the product.
6. DO NOT overreach. Keep proper footing and balance at all times when operating this product.
7. Check for damage. Check your product regularly. If part of the product is damaged, it should be carefully inspected to make sure that it can perform its intended function correctly. If in doubt, discontinue use of product.
8. Keep away from flammables. DO NOT attempt to operate this product near flammable materials or combustibles. Failure to comply may cause serious injury or death.
9. Store this product out of the reach of children and untrained persons. This product may be dangerous in the hands of untrained users.
10. Keep this product dry and clean.
11. Use only accessories that are recommended by the manufacturer for your model. Accessories that may be suitable for one product may become hazardous when used on another product.
12. Service must be performed only by qualified repair personnel. Service or maintenance performed by unqualified personnel could result in a risk of injury.
13. When servicing a product, use only identical replacement parts. Use of unauthorized parts or failure to follow maintenance instructions may create a risk of injury.
14. Maintain a safe working environment. Keep the work area well lit. Make sure there is adequate surrounding workspace. Keep the work area free of obstructions, grease, oil, trash, and other debris. DO NOT use this product in a damp or wet location.
15. Maintain labels and nameplates on this product. These carry important information. If unreadable or missing, contact Essentials® for a replacement.
16. Avoid accidental fire and/or explosion. DO NOT smoke near this product.
17. The warnings, precautions, and instructions discussed in this manual cannot cover all possible conditions and situations that may occur. The operator must understand that common sense and caution are factors which cannot be built into this product, but must be supplied by the operator.
18. We believe the information contained herein to be reliable. However, general technical information is given by us without charge and the user shall employ such information at their own discretion and risk. We assume no responsibility for results or damages incurred from the use of such information in whole or in part.
19. The manufacturer declines any and all responsibility for property damage or injury if said damage is the result of unskillful handling by the operator or of failure to observe the basic safety rules set forth in the instruction manual.
20. The procedures documented in this manual are to serve as guidelines for the use of this equipment.
21. The use of this equipment is simple and straightforward if you follow the instructions. When operating this equipment, use common sense, and only use this Heater for its intended purpose.

PRODUCT DESCRIPTION

The Essentials® 24823 Portable Electric Space Heater is a convenient way to heat work areas safely and effectively. The Space Heater operates on 120 volts, 1300 or 1500 Watt settings, and includes the following features: Tip-Over Switch, Over-Temperature Safety Cutoff, Pilot light, Fan-Only Operation, and Thermostat Control. The tip-over switch and over-temperature safety cutoff automatically turns the unit off when the unit is tipped over. The pilot light glows when heater is operating. The thermostat control and fan-only operation features allow versatility and efficiency of operation.

PRODUCT SPECIFICATIONS

INPUT VOLTAGE	120V
OUTPUT WATTAGE	1300 - 1500W
AMPERAGE	12.5A
HEATING METHOD	Fan Forced
PLUG TYPE	Nema 5-15P
CORD LENGTH	72"
HEATING AREA	150 Sq. Ft.
DIMENSIONS	16" (Height) x 8" (Width) x 10" (Depth)

CONTENTS

1500W 120V Portable Electric Space Heater (1) and Instruction Manual (1)

SPECIFIC SAFETY INSTRUCTIONS AND WARNINGS

⚠ WARNING: DO NOT store or use gasoline or other flammable vapors/liquids in the vicinity of this heater.

⚠ WARNING: Extreme caution should be exercised when using heaters near children or pets.

⚠ WARNING: When using electrical appliances, basic precautions should always be followed to reduce the risk of fire, electric shock and injury to persons, including the following instructions:

1. Use handle to move heater. Heater becomes hot when in use. To avoid burns, DO NOT let bare skin touch hot surfaces.
2. Extreme caution is necessary when heater is used near children or pets and whenever heater is operating and unattended.
3. To disconnect heater, turn selector knob to "OFF" position. Then remove plug from outlet.
4. Always unplug heater when not in use.
5. DO NOT operate any heater with a damaged cord or plug. If heater malfunctions, due to being dropped or damaged, it must be repaired by a qualified electrician.
6. DO NOT use outdoors.
7. This heater is NOT suitable for use in wet or very humid locations. NEVER place near an open container of water or bathtub into which heater could fall.
8. DO NOT run cord under carpeting or cover with throw rugs, runners, etc. To prevent tripping or damage, keep cord away from high traffic areas.

9. DO NOT insert foreign objects in any ventilation or exhaust opening as this may result in an electric shock, fire, or damage to the heater.
10. To prevent a possible fire, DO NOT block air intakes or exhaust. DO NOT use on soft surfaces, like a bed, where openings may become blocked.
11. Keep combustibles such as furniture, pillows, bedding, papers, clothes and curtains at least 3 Ft. (0.9 m) from front, sides, and rear of heater.
12. DO NOT operate in areas where gasoline, paint, or flammable liquids are used or stored. A heater has hot, arcing or sparking parts inside which can ignite fumes.
13. Connect heater to properly grounded outlets only.
14. Always plug heater directly into a wall outlet/receptacle. NEVER use with an extension cord or relocatable power tap (outlet/power strip).
15. Use heater only as described in this manual. Other uses not recommended by the manufacturer may cause fire, electric shock, or personal injury.
16. The heater is provided with a manual reset over-temperature control that turns heater off if overheating occurs. Immediately turn the heater off. Before resetting, be certain that the overheating problem has been corrected and heater is not damaged. DO NOT use heater if heater repeatedly cycles off on this safety device. To reset the heater, turn it off and unplug it from the outlet. Wait until the heater cools down. and the safety switch will be reset.
17. NEVER clean this heater while it is plugged in. DO NOT immerse in water. To disconnect, turn control to OFF, then remove the plug from the outlet by grasping it and pulling it from the outlet. NEVER yank on the cord.
18. Check your heater cord and plug connections. A loose-fitting outlet can cause the plug to overheat and/or cause a fire. Be sure the plug fits tight in the outlet. Check frequently during use to make sure plug and outlet are not hot. If so, discontinue using heater and have outlet replaced by a qualified electrician.

NOTE: Heaters draw more current than small appliances. Overheating of the outlet may occur even if it has not occurred with the other appliances.

INSTALLATION

This heater comes with a grounded (3 blade) plug.

WARNING: The grounded plug must be used with a grounded outlet. DO NOT use an adapter in a 2-slot wall outlet unless the ground plug of the adapter properly connects to a building ground. Using heater without properly grounded outlet or adapter could result in an electric shock hazard.

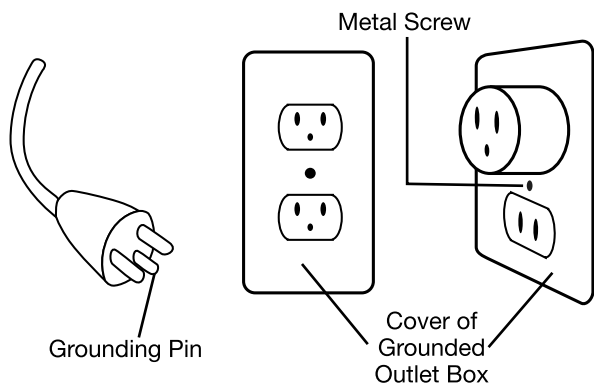

OPERATION

WARNING: Follow the information in this manual exactly; a fire may result causing property damage, personal injury or loss of life.

WARNING: Electrical outlet wiring must comply with local building codes and other applicable regulations to reduce risk of fire, electrical shock and operator injury.

1. Plug the heater cord directly into a standard grounded 120-Volt AC outlet. Operate the heater in the upright position with its rubber feet on the floor.
2. Turn wattage selector knob to the "1500W" position to provide the maximum heat output.
3. Turn the thermostat knob clockwise (right) to "HIGH". The heater will begin heating and the fan starts blowing warm air.
4. When the room temperature reaches the desired comfort level, slowly rotate the thermostat knob counterclockwise (left) until the heater shuts off. At this setting, the heater will automatically cycle on and off to maintain this temperature.

NOTE: DO NOT force the knob beyond its normal stopping position. Only minor adjustments to the thermostat should be necessary to maintain the desired comfort level. Turning clockwise will increase the room temperature and counterclockwise will decrease the temperature.

5. To conserve energy, the heater may operate at lower wattage by turning control knob to the "1300W" position.
6. When heater is not needed, turn selector switch to the "OFF" position. Then remove the plug from outlet.

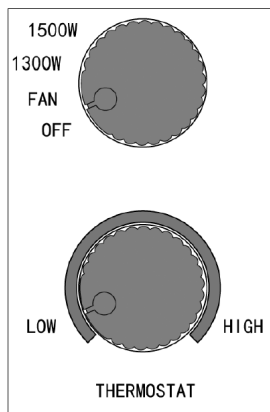

IMPORTANT: The heating coils on your heater do not glow. Coil elements are normally dark. Air movement through these coils prevents glowing while providing comfortable heat, similar to a forced-air furnace. Some glow may occur where the air movement does not directly touch the coils.

MAINTENANCE

WARNING: DO NOT attempt to clean the heater while it is in operation.

WARNING: No serviceable parts.

WARNING: DO NOT open the unit or motor or attempt to repair.

This heater does not require routine maintenance other than an occasional cleaning. To prevent clogging of intake grille openings, clean air intake grille by using a vacuum with brush attachment or high-pressure air.

CLEANING AND STORAGE

Store the Heater in an upright position and in a clean, dry area. DO NOT store near flammable items or open flames.

Turn selector switch to the "OFF" position, then remove plug from electrical outlet before cleaning. Use a soft cloth. For cleaning, use only a damp rag and nonabrasive dish detergent, as abrasive or chemical cleaners may harm the finish. If heater is used in a dusty

essentials®

PORTABLE ELECTRIC SPACE HEATER

area, use a vacuum cleaner dust brush to remove dust and other foreign particles from grilles. Use compressed air to blow out heater when interior is dirty or clogged. Keep heater in a safe location for storage. Always unplug heater when not in use.

⚠WARNING: DO NOT attempt to service the unit yourself.

LUBRICATION

The motor is permanently lubricated.

TROUBLESHOOTING

PROBLEM	CAUSE	SOLUTION
Your heater shuts off unexpectedly or fails to operate	<ol style="list-style-type: none"> 1. No electric power. 2. One of the safety features may have activated to prevent overheating, including the Tip-Over Switch and Over-Temperature Safety Cutoff Switch. 	<ol style="list-style-type: none"> 1. Be sure the power cord is plugged into a working electrical outlet. 2. a. Check your thermostat setting. The heater may be off because it has reached the desired temperature setting. b. Unplug the heater and wait 10 minutes for the unit to cool down. After 10 minutes, plug the unit in again and operate normally.

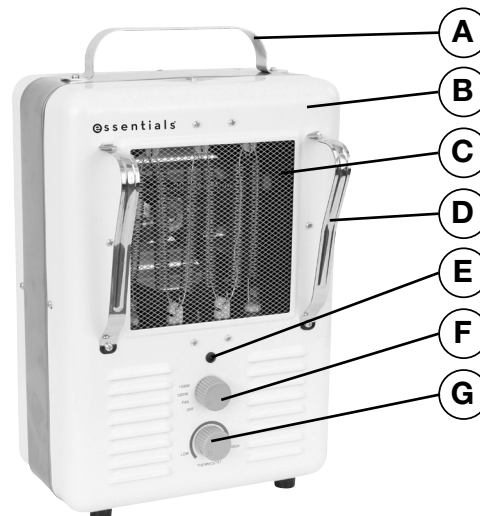

FIGURE	DESCRIPTION
A	Handle
B	Frame
C	Heating Element and Output
D	Protective Front Guards
E	Power Indicator
F	Selector Control Dial
G	Thermostat Dial

NOTE: Essentials® and/or its distributors have provided the parts list and assembly diagram as a reference only. Neither Essentials® and/or its distributors make any representation or warranty of any kind to the buyer and/or user of this tool that he or she is qualified to do any repairs or replace any parts of this product. Essentials® and its distributors expressly state that all repairs or parts replacement should be done by certified or licensed technicians. The buyer assumes all risk and liability arising out of his or her repairs or parts replacement to the original product.

ESSENTIALS® ONE YEAR LIMITED WARRANTY

If within one year from the date of purchase you find any defect in material or workmanship in this Essentials® product, through normal usage, either return it to the place of purchase, or send it to Essentials® for repair or replacement at our discretion. In order to obtain this service, send your tool and proof of purchase, transportation pre-paid, to Essentials® LLC Q.A. Dept., 3580 E. Raines Road #3, Memphis, TN 38118. We will not be responsible for lost or damaged goods during transportation; please insure your package.

Essentials® does not provide any warranty for products labeled other than Essentials® LLC. Essentials® will not provide any warranty for products subjected to abnormal use. Abnormal use includes, but is not limited to, abuse, accident, alteration, neglect, and unauthorized or unreasonable use or repairs. This warranty does not cover blades, bits, files, sheathes, cases, accessories, bulbs, batteries, calibration, or finishes. We recommend that you maintain your tools and sharpen or replace blades, batteries, bits and files as necessary. Essentials® reserves the right to make any changes in construction or design at any time without any obligation in incorporating such changes to tools or equipment previously sold.

Essentials® is not liable for consequential or incidental damages arising from the breach of this, or any other, warranty whether expressed, implied, or statutory. Some states do not allow the exclusion or limitation of incidental or consequential damages, so the above exclusion may not apply to you.

This warranty gives you specific legal rights, and you may also have other rights, which vary from state to state.

This product is not guaranteed if used for industrial or commercial purposes. Please visit our website for full warranty information.

TOLL FREE HELPLINE: 1-866-458-2472.

CONTACT US

3580 E. Raines Road, Suite 3, Memphis, TN 38118
 Tel: 1-866-458-2472
 www.greatnecksaw.com